

# Product Datasheet

## EXP-MH-14K/1500-P EXP-MH-14KS/1500-P Polar Emergency Tank Shower

Designed for severely cold climates the polar tank shower, with optional eye/face wash unit, incorporates a double-skinned fibreglass insulated cubicle to protect the user from the elements. Double swing push open doors provide unimpeded access while the integral immersion heater maintains a constant temperature. Windows in the doors enable the casualty to be monitored whilst using the shower in case assistance is required. Optional air heater available to maintain the internal cubicle temperature.



## Specifications

### TECHNICAL DATA

INLET CONNECTION SIZE & TYPE	3/4" BSP Female
SHOWER OPERATION	Panic bar (optional foot panel control)
EYE/FACE WASH OPERATION	Pull lid forward (optional foot treadle control)
SUPPLY PRESSURE	0.5 to 10 BAR G (7 to 145 PSI)
FLOW AT OPERATING PRESSURE	Shower - 76 litres/minute (20 US gallons). Eye/Face wash - 12 litres/minute (3 US gallons)
ELECTRICAL EQUIPMENT - Non-hazardous	Suitable for use in areas classified as non-hazardous
ELECTRICAL EQUIPMENT - Hazardous	ATEX Zone 1 & 2. Gas groups IIA & IIB. Temp Class T3 (IIC available)
ELECTRICAL SUPPLY	230V, single phase, 50Hz (110V optional)
IMMERSION HEATER	3000W - 230V or 1700W

### MATERIALS OF CONSTRUCTION

SHOWER ROSE GRP	Stainless steel
PIPING & VALVE MATERIALS	uPVC and stainless steel
CONTROL VALVE - SHOWER	uPVC 1 1/2" BSP ball valve
CONTROL VALVE - EYE/FACE WASH	1/2" stainless steel full flow ball valve with stainless steel ball
EYE/FACE WASH STRAINER	1/2" Stainless Steel
OVERFLOW	1" BSP uPVC
BALLCOCK VALVE	2 x 1/2" BSP brass
SHOWER VALVE LEVERS	Red reinforced nylon 6
EYE/FACE WASH VALVE LEVERS	Stainless steel
WATER TANK	1500 litre capacity heavy density polyethylene HDPE
TANK SURROUND AND LID	Heavy-duty GRP in white (green or yellow available)
SHOWER FRAME AND LEGS (K)	Galvanised steel
SHOWER FRAME AND LEGS (KS)	Stainless steel. Polished brush finish. (paint options available)
INSULATION	40mm thick foil backed polyurethane
PANIC BAR FOR VALVE ACTIVATION	Stainless steel - powder coated red
FOOT CONTROL OPTIONS	Panel foot control - GRP/Treadle foot control - powder coated stainless steel
ALL FASTENERS AND FIXINGS	Stainless steel

### ENVIRONMENTAL OPERATING TEMPERATURE

MINIMUM AMBIENT OPERATING TEMPERATURE	-35° C (-31° F)
---------------------------------------	-----------------

### WEIGHTS AND DIMENSIONS

DIMENSIONS (WxDxH)	1420mm (55.9in) x 1495mm (58.9in) x 3916 mm (154in)
1500 LITRE - no options	620kg (1367lb)

# HUGHES



HUGHES-SAFETY.COM

Justrite Safety Group

www.hughes-safety.com

**EXP-J-14K/1500-P**  
**EXP-J-14KS/1500-P**

*Polar Emergency Tank Shower*

**OPTIONAL FITTINGS**

GRP PANELLING TO 3 SIDES

SUN SHIELDS - SET

SUMP FRAME & FOOT GRATING

SHOWER PANEL FOOT CONTROL

EYE WASH TREADLE FOOT CONTROL

EYE/FACE WASH

POINTER LEVEL INDICATOR

TEMPERATURE INDICATOR 4" DIAL

IMMERSSION HEATER - FLP

IMMERSSION HEATER - NON FLP

CHILLER UNIT - FLP

CHILLER UNIT - NON FLP

LIGHT - FLP

LIGHT - NON FLP

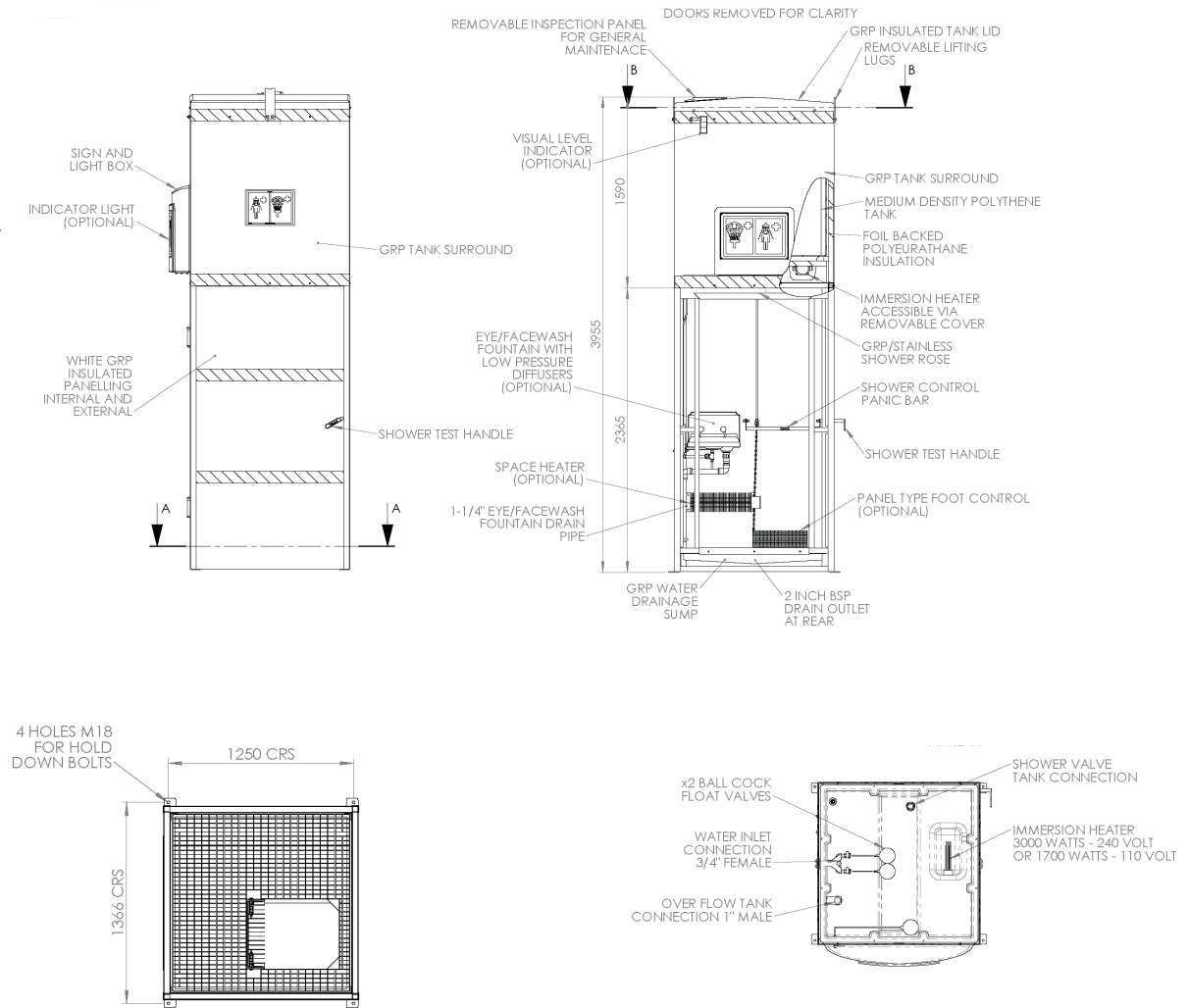

**HUGHES**



**HUGHES-SAFETY.COM**

Justrite Safety Group

Hughes Safety Showers Ltd, Whitefield Road, Bredbury, Stockport SK6 2SS UK.

Email: [sales@hughes-safety.com](mailto:sales@hughes-safety.com)

Tel: +44 (0)161 430 6618

Registered No. 0939240. VAT Registration No. 918 5005 32. Hughes Safety Showers Ltd is a Justrite Group Company.

V1.4